

MCI 102 SERIES PARTS MANUAL

Date 10-1-92

Page 12.0201

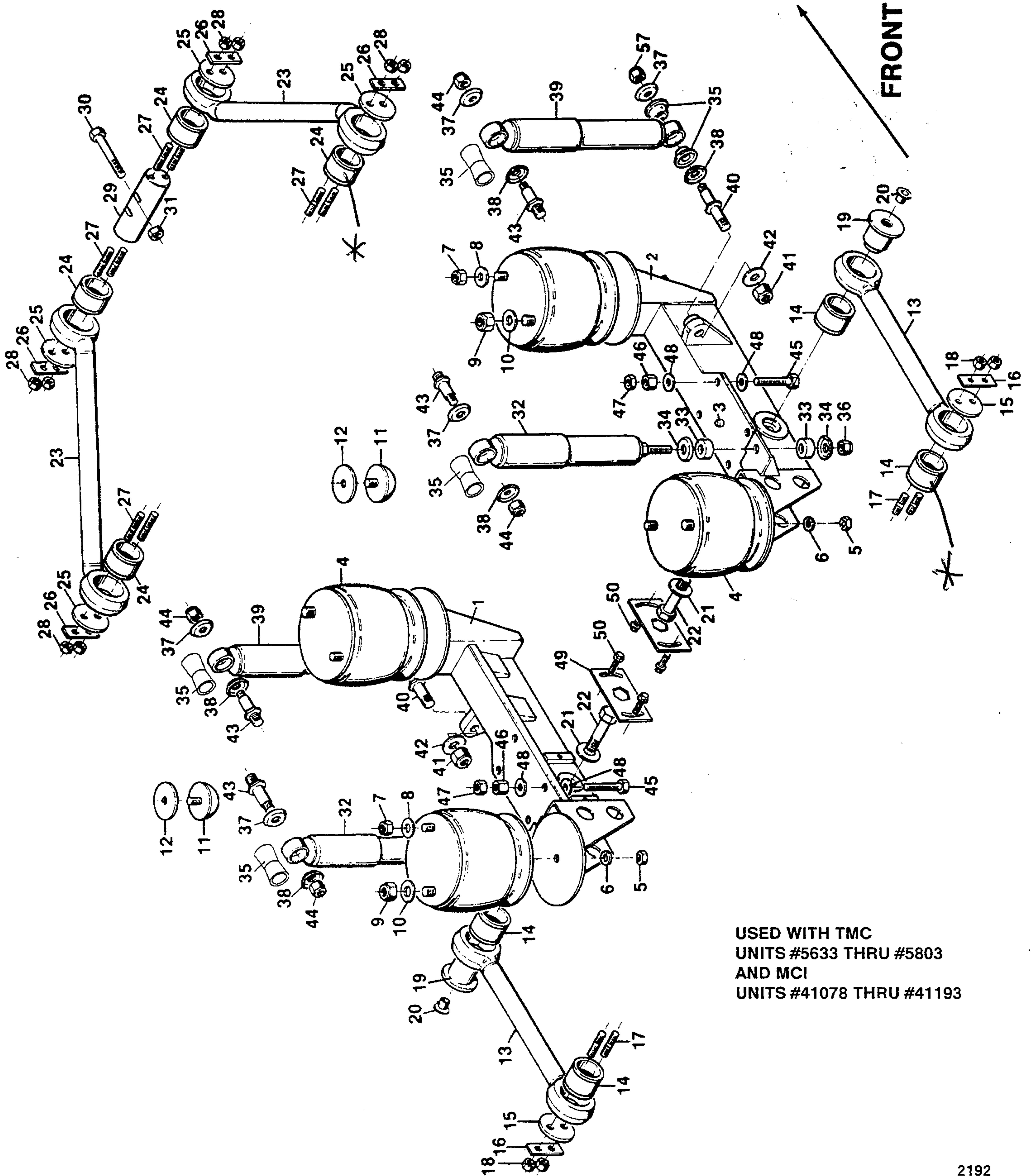

USED WITH TMC
UNITS #5633 THRU #5803
AND MCI
UNITS #41078 THRU #41193

**SUSPENSION ASSEMBLY - REAR DRIVE AXLE
(USED PRIOR TO TMC UNIT #5803 & MCI UNIT #41193)**

MCI 102 SERIES PARTS MANUAL

Date 10-1-92

Page 12.0202

Key	Part Number	Description	Note	Qty	
				2 Axle	3 Axle
SUSPENSION ASSEMBLY - REAR DRIVE AXLE					
(USED PRIOR TO TMC UNIT #5803 & MCI UNIT #41193)					
1	12K-3-12	Suspension Support Assy - LH/Rear		1	1
2	12K-3-16	Suspension Support Assy - RH/Rear		1	1
3	12C-3-10	Pin - Axle Centering		1	1
4	12J-3-53	Air Spring - Rear Suspension		4	-
	12K-3-11	Air Spring - Rear Suspension		-	4
5	19-3-188	Nut (1/2-13)		4	4
6	19-2-29	Lockwasher (1/2) Mount Air/Suspension Support		4	4
7	19-3-188	Locknut (Hex) Mount Air Spring/Bogie		4	4
8	19-2-10	Flatwasher (1/2) Mount Air Spring/Bogie and Suspension Support		4	4
9	7C-3-12	Locknut (3/4-16) Hex		4	4
10	19-2-12	Flatwasher - Mount Air Spring/Bogie at Air Ftg Stud		4	4
11	12G-1-5	Bumper - Bogie LH/RH (Rubber)		2	2
12	12R-1-6	Spacer - Between Bumper & Bogie LH/RH		2	2
13	12J-3-46	Radius Rod - Lower Rear LH/RH		2	2
14	12J-1-26	Bushing - Radius Rod		2	2
15	12-1-208	Washer - Mount Radius Rod LH/RH		2	2
16	12-1-211	Plate - Radius Rod Stud Nut Locking LH/RH		2	2
17	12-1-207	Stud (3/4-16) Mount Lower Radius Rod LH/RH		4	4
18	19-3-109	Nut (3/4-16) Hex - Mount Lower Radius Rod LH/RH		4	4
19	12J-3-147	Retainer Pin - Lower Rear Radius Rod to Support LH/RH		2	2
20	19-8-65	Plug - Closing Radius Rod Retainer Hole (Plastic)		2	2
21	12J-3-58	Washer (Hdn) Mount Lower Radius Rod at Suspension Support LH/RH		2	2
22	19-1-973	Capscrew (1-1/4-12 x 4-1/2) Mount Lower Radius Rod at Susp Support LH/RH		2	2
23	12K-3-1	Radius Rod - Upper Rear LH/RH		2	2
24	12J-1-133	Bushing		2	2
25	12J-1-208	Washer - Radius Rod Mount LH/RH		4	4
26	12-1-211	Plate - Radius Rod Stud Nut Locking LH/RH		4	4
27	12-1-207	Stud (3/4-16) Mount Upper Radius Rod LH/RH		8	8
28	19-3-109	Nut (3/4-16) Hex - Mount Upper Radius Rod LH/RH		8	8
29	2B-2-26	Pin - Upper Radius Rod Anchor		1	1
30	19-1-311	Capscrew (5/8-18 x 5) Hex - Clamping Pin in Upper Radius Rod Anchor		2	2
31	19-3-153	Locknut (5/8-18) Clamping Pin in Upper Radius Rod Anchor		2	2
32	12J-5-4	Shock Absorber - Rear of Rear Suspension		2	2
33	12J-3-107	Bushing - Shock Absorber Driver		8	8
34	12J-3-104	Washer - Lower Retaining		8	8
35	12J-5-5	Bushing - Shock Absorber Upper		4	4
36	19-3-153	Nut - Lower Shock Retaining		4	4
37	12J-3-195	Washer - Retaining Shock Absorber		4	4
38	12J-3-106	Washer - Retaining Shock Absorber		4	4
39	12J-5-3	Shock Absorber - Front of Rear Suspension		2	2
40	12J-1-67	Pin - Shock Absorber Mount Lower Front		2	2
41	12J-1-32	Stover Nut - Retaining Shock Absorber		2	2
42	12J-1-31	Washer (Hdn) Retaining Shock Absorber		2	2
43	12J-1-68	Pin - Mount Shock Absorber to Rear Bogie		4	4
44	19-3-7	Nut (3/4-16) Retaining Shock Absorber		6	6
45	12C-3-27	Capscrew (3/4-16 x 3)		8	8
46	19-3-108	Nut (High) Hex - Mount Axle/Suspension Support LH/RH		8	8
47	19-3-112	Nut (Jam) Hex		8	8
48	3J-56-146	Washer (Hdn) Mount Door Axle/Suspension Support LH/RH		1	1
49	12J-3-154	Plate - Bolt Retainer LH/RH		2	2
50	19-1-22	Capscrew (3/8-16 x 3/4) Bolt Retainer LH/RH		4	4
	19-2-27	Lockwasher - Used with 19-1-22		4	4
	19-2-9	Flatwasher - Used with 19-1-22		4	4

MCI 102 SERIES PARTS MANUAL

Date 10-1-92

Page 12.0203

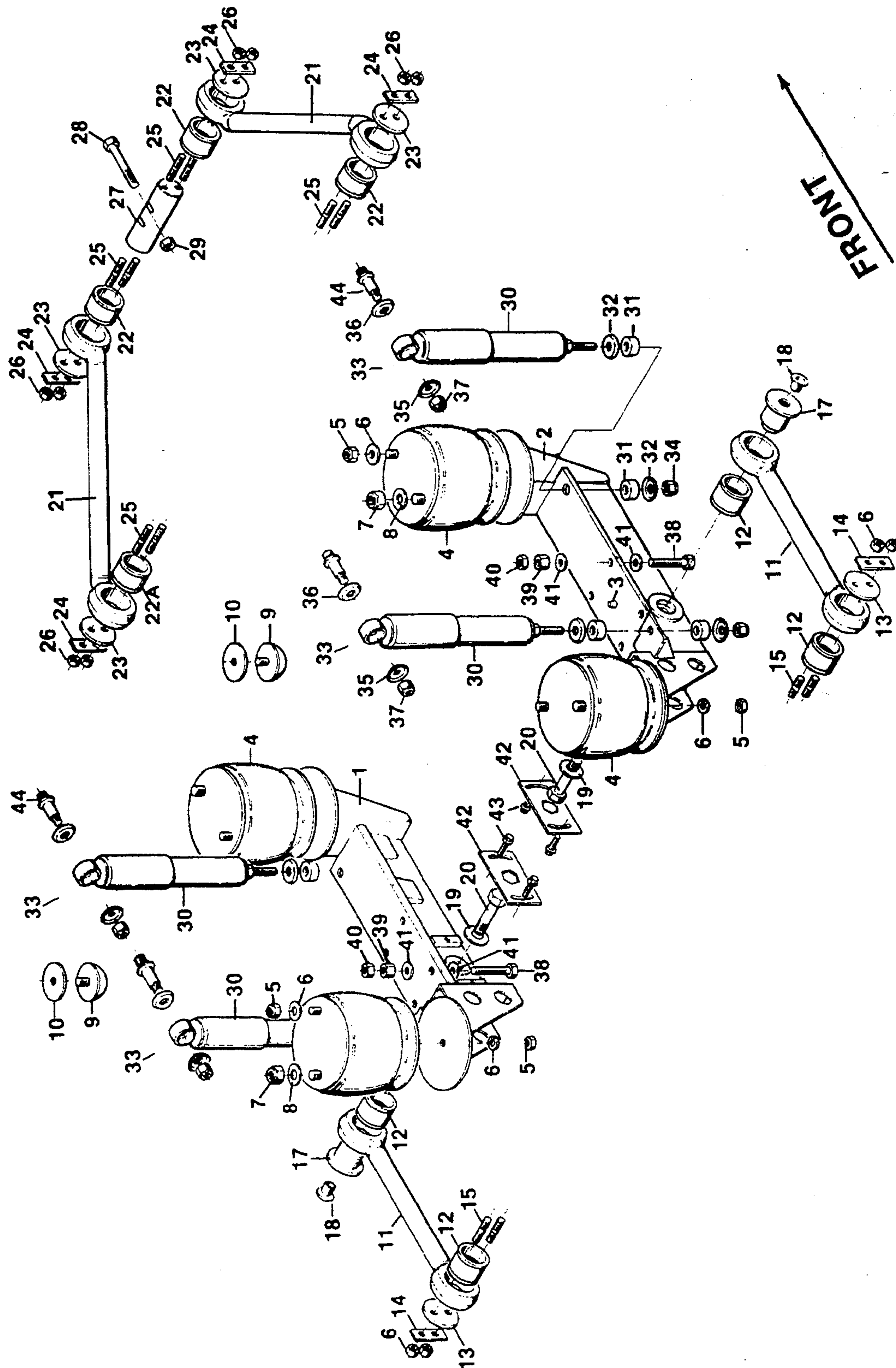

2193

**SUSPENSION ASSEMBLY - REAR DRIVE AXLE
(EFFECTIVE WITH TMC UNIT #5803 & MCI UNIT # 41193)**

MCI 102 SERIES PARTS MANUAL

Date 10-1-92

Page 12.0204

Key	Part Number	Description	Note	Qty	
				2 Axle	3 Axle
SUSPENSION ASSEMBLY - REAR DRIVE AXLE (EFFECTIVE WITH TMC UNIT #5803 & MCI UNIT #41193)					
1	12K-3-28	Suspension Support Assy - LH Rear		1	1
2	12K-3-40	Suspension Support Assy - RH Rear		1	1
3	12C-3-10	Pin - Axle Centering		1	1
4	12K-3-11	Air Spring - Rear Suspension		4	4
5	19-3-188	Locknut (1/2-13) Hex - Mount Air Spring/Bogie & Suspension Support		8	8
6	19-2-10	Flatwasher (1/2) Mount Air Spring/Suspension Support		8	8
7	7C-3-12	Locknut (3/4-16) Hex		4	4
8	19-2-12	Flatwasher - Mount Air Spring/Bogie at Air Ftg Stud		4	4
9	12G-1-5	Bumper (Rub) Bogie LH/RH		2	2
10	12R-1-6	Spacer (1/2) Between Bumper & Bogie LH/RH		2	2
11	12J-3-46	Radius Rod - Lower Rear LH/RH		2	2
12	12J-1-26	Bushing - Radius Rod Lower		2	2
13	12-1-208	Washer - Mount Radius Rod LH/RH		2	2
14	12-1-211	Plate - Radius Rod Stud Nut Locking LH/RH		2	2
15	12-1-207	Stud (3/4-16) Mount Lower Radius Rod LH/RH		4	4
16	19-3-109	Nut (3/4-16) Hex - Mount Lower Radius Rod LH/RH		4	4
17	12J-3-147	Retainer Pin - Lower Rear Radius to Supports LH/RH		2	2
18	19-8-65	Plug - Closing Retainer Hole Plastic		2	2
19	12J-3-58	Washer - Mount Lower Radius Rod at Suspension Support LH/RH		2	2
20	19-1-973	Capscrew (1-1/4-12 x 4-1/2) Mount Lower Radius Rod at Susp Support LH/RH		2	2
21	12K-3-1	Radius Rod - Upper Rear LH/RH		2	2
22	12J-1-133	Bushing		4	4
23	12J-1-208	Washer - Radius Rod Mount LH/RH		4	4
24	12-1-211	Plate - Radius Rod Stud Nut Locking LH/RH		4	4
25	12-1-207	Stud (3/4-16) Mount Upper Radius Rod LH/RH		8	8
26	19-3-109	Nut (3/4-16) Hex - Mount Upper Radius Rod LH/RH		8	8
27	2B-2-26	Pin - Upper Radius Rod Anchor		1	1
28	19-1-311	Capscrew - (5/8-18 x 5) Clamping Pin/Upper Radius Rod Anchor		2	2
29	19-3-153	Locknut - (5/8-18) Clamping Pin/Upper Radius Rod Anchor		2	2
30	12J-5-4	Shock Absorber Assy - Front & Rear of Rear Suspension		4	4
31	12J-3-107	Bushing - Shock Absorber Lower		2	2
32	12J-3-104	Washer - Lower Retaining		2	2
33	12J-5-5	Bushing - Shock Absorber Upper		4	4
34	19-3-153	Nut - Lower Shock Retaining		4	4
35	12J-3-105	Washer - Retaining Shock Absorber		4	4
36	12J-3-106	Washer - Retaining Shock Absorber		4	4
37	19-3-7	Hex Nut - (3/4-16) Retaining Shock Absorber		4	4
38	12C-3-27	Capscrew - (3/4-16 x 3)		8	8
39	19-3-108	Hex Nut (High) - Mount Axle/Suspension Support LH/RH		8	8
40	19-3-112	Nut Jam Hex - Mount Axle		8	8
41	3J-56-146	Washer - Mount Axle/Suspension Support LH/RH		16	16
42	12J-3-154	Plate - Bolt Retainer LH/RH		2	2
43	19-1-22	Capscrew (3/8-16 x 3/4) Bolt Retainer LH/RH		4	4
	19-2-27	Lockwasher - Mount Retainer		4	4
	19-2-9	Flatwasher - Mount Retainer		4	4
44	12J-5-68	Pin - Mount Shock Absorber to Rear Bogie		4	4

MCI 102 SERIES PARTS MANUAL

Date 10-1-92

Page 12.0205

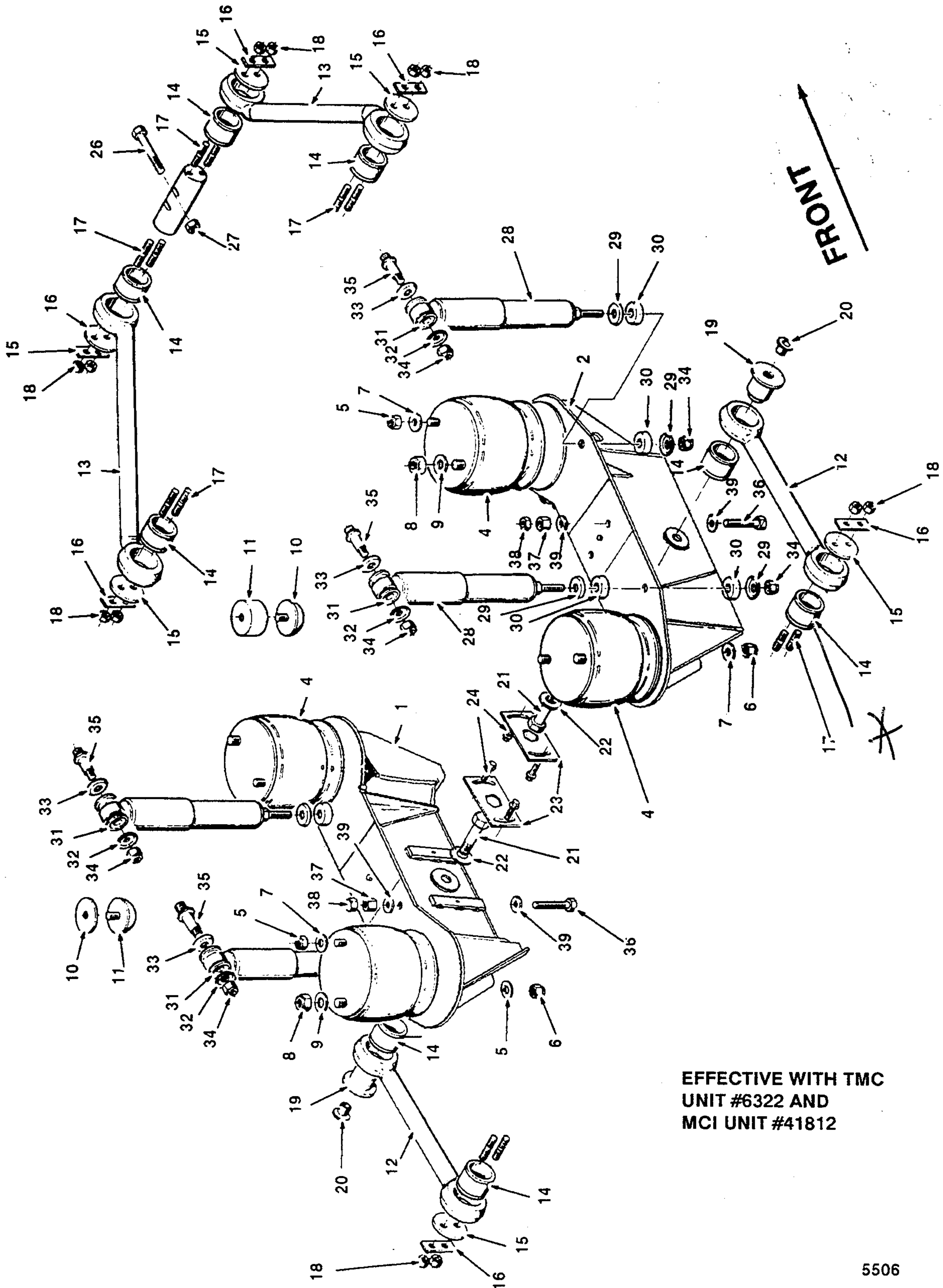

EFFECTIVE WITH TMC
UNIT #6322 AND
MCI UNIT #41812

5506

**SUSPENSION ASSEMBLY - REAR DRIVE AXLE
(EFFECTIVE WITH TMC UNIT #6322 & MCI UNIT #41812)**

MCI 102 SERIES PARTS MANUAL

Date 10-1-92

Page 12.0206

Key	Part Number	Description	Note	Qty	
				2 Axle	3 Axle
SUSPENSION ASSEMBLY - REAR DRIVE AXLE (EFFECTIVE WITH TMC UNIT #6322 & MCI UNIT #41812)					
1	12K-3-44	Suspension Support Assy - LH Rear	a	1	1
	12K-3-106	Suspension Support Assy - LH Rear	b	1	-
	12K-3-97	Suspension Support Assy - LH Rear	b	-	1
2	12K-3-45	Suspension Support Assy - RH Rear	a	1	1
	12K-3-107	Suspension Support Assy - RH Rear	b	1	-
	12K-3-88	Suspension Support Assy - RH Rear	b	-	1
3	12C-3-10	Pin - Axle Centering		1	1
4	12G-1-60	Air Spring Assembly	a	4	4
	12K-1-45	Air Spring Assembly	b	4	4
5	19-3-188	Hex Locknut - Mount Air Spring To Bogie (1/2-13)		4	4
6	19-3-429	Hex Locknut - Mount Air Spring To Suspension Support (1/2-13)		4	4
7	19-2-10	Flatwasher - Mount Air Spring To Bogie And Suspension Support (1/2)		8	8
8	7C-3-12	Hex Locknut - Mount Air Spring To Bogie at Air Fitting Stud (3/4-16) Hex		4	4
9	19-2-12	Flatwasher - Mount Air Spring To Bogie at Air Fitting Stud (3/4)		4	4
10	12G-1-5	Bumper - Joist Bracket Rubber LH/RH		2	2
11	12R-1-6	Spacer - Between Bumper & Bogie LH/RH		2	2
12	12J-3-46	Radius Rod Assy - Suspension Support Rear Lower LH/RH	c	2	2
	12J-1-26	Bushing - Radius Rod Lower	c	2	2
	12J-3-198	Radius Rod - Suspension Support To Bogie Lower LH/RH	d	2	2
13	12K-3-1	Radius Rod - Upper Rear LH/RH	c	2	2
	12K-3-59	Radius Rod - Upper Rear LH/RH	d	2	2
14	12J-1-133	Bushing		2	2
15	12-1-208	Washer - Mount Radius Rod To Bogie/Support LH/RH		6	6
16	12-1-211	Plate - Locking Radius Rod Stud Nut LH/RH		6	6
17	12-1-207	Stud - Mount Radius Rod At Support/Bogie/Axle (3/4-16 x 4)		12	12
18	19-3-109	Hex Nut - Radius Rod Studs LH/RH (3/4-16)		12	12
19	12J-3-147	Retainer Pin - Lower Rear Radius Rod to Support LH/RH (Concentric)	g	2	2
	12L-3-54	Retainer Pin - Lower Rear Radius Rod to Support LH/RH (Eccentric)	h	-	2
20	19-8-69	Plug - Closing Retainer Hole (Plastic)		2	2
21	19-1-973	Capscrew - Mount Radius Rod To Support LH/RH (1-1/4-12 x 4-1/2)		2	2
22	12J-3-58	Flatwasher - Radius Rod Mounting Capscrew LH/RH		2	2
23	12J-3-154	Plate - Locking Radius Rod Capscrew LH/RH		2	2
24	19-1-519	Capscrew - Mount Locking Plate (3/8-16 x 5/8)		4	4
	19-2-27	Lockwasher - Mount Locking Plate		4	4
	19-2-9	Flatwasher - Mount Locking Plate		4	4
25	2B-2-26	Pin - Upper Radius Rod Anchor At Axle		1	1
26	19-1-311	Capscrew - Clamping Pin to Axle Bracket (5/8-18 x 5)		2	2
27	19-3-153	Locknut - Clamping Pin To Axle Bracket (5/8-18)		2	2
28	12J-5-4	Shock Absorber - Rear Suspension LH/RH	e	4	4
29	12J-3-104	Washer - Mount Shock to Suspension Support	e	2	2
30	12J-3-107	Bushing - Mount Shock to Suspension Support	e	2	2
31	12J-5-5	Bushing - Mount Shock Absorber Upper	e	8	8
	12J-5-10	Shock Absorber Assy - Rear Suspension LH/RH	f	4	4
28	12J-5-7	Shock Absorber - Rear	f	1	1
29	12J-3-104	Washer - Mount Shock to Suspension Support	f	2	2
30	12J-3-107	Bushing - Mount Shock to Suspension Support	f	2	2
	12J-5-5	Bushing - Mount Shock Absorber Upper	f	1	1
32	12J-3-105	Washer - Retaining Shock Absorber Nut Side		4	4
33	12J-3-106	Washer - Retaining Shock Absorber Pin Side		4	4
34	19-3-7	Hex Locknut - Mount Shock Absorber To Pin (3/4-16)		8	8
35	12J-5-8	Pin - Shock Mount		4	4
36	12C-3-27	Capscrew - Mount Axle To Supports (3/4-16 x 3)		8	8
37	19-3-108	Hex Nut - Mount Axle To Support (3/4-16)		8	8
38	19-3-112	Hex Jam Nut - Mount Axle To Support (3/4-16)		8	8
39	2J-6-24	Flatwasher - Mount Axle To Support LH/RH		16	16
<p>NOTES:</p> <p>a. Used prior to TMC Unit #7404 and MCI Unit #43096.</p> <p>b. Effective with TMC Unit #7404 and MCI Unit #43096.</p> <p>c. Used prior to TMC Unit #6930 and MCI Unit #42659.</p> <p>d. Effective with TMC Unit #6930 and MCI Unit #42659.</p> <p>e. Used prior to TMC Unit #6395 and MCI Unit #41812.</p> <p>f. Effective with TMC Unit #6395 and MCI Unit #41812.</p> <p>g. Used prior to MCI Unit #44302 (Planned).</p> <p>h. Effective with MCI Unit #44302 (Planned).</p>					